

S Sandberg®

ACTIVE 

Mini Air Pump Lantern

Quick guide

420-93



S Sandberg®

Mini Air Pump
Lantern

Item no. 420-93

www.sandberg.world

Sandberg A/S

Bregnerødvej 133D,
3460 Birkerød, Denmark

UK
CA
FC



Made in China



Double
Quality
Tested

www.sandberg.world

5

Years
Warranty

Warranty

There is a five-year warranty on your Sandberg product.
Please read the warranty terms and register your new
Sandberg product at www.sandberg.world/warranty



Support: <http://helpdesk.sandberg.world>



For information on handling electronic waste, see www.sandberg.world/weee

Product overview

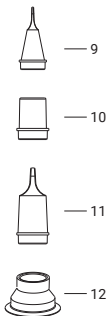
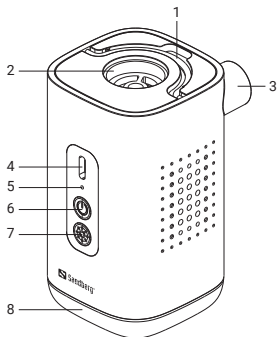

1. Metal hanging ring
2. Deflation port
3. Inflation port
4. USB-C charging
5. Battery indicator
6. Power ON/OFF
7. LED lighting switch
8. LED Lantern
9. Small nozzle
10. Medium nozzle
11. Large nozzle
12. Vacuum nozzle

Charging

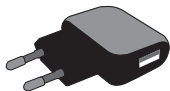

USB AC charger



USB

USB-C

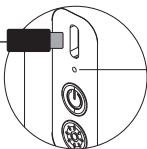

- Battery below 30%
- Fully charged

How to install nozzles

For Inflatables.

Choose a suitable nozzle when deflating and install it to top inlet (2).

Choose a suitable nozzle when inflating and install it to the side outlet (3).

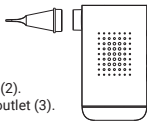

For equipment with double valve.

Open the first valve, and use the medium nozzle to inflate.

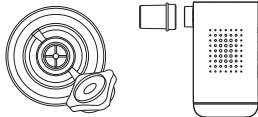

Open the second valve, and use the medium nozzle and the vacuum nozzle, which can quickly inflate.

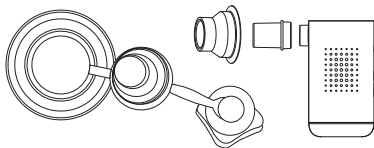

Note: When using the small nozzle for inflation, the valve of swimming pool needs to be opened by the tip of small nozzle. Then it can inflate quickly.



Small valve



Use the tip of small nozzle to open valve of inflatables

Power ON/OFF

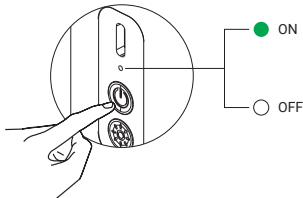

Press and hold for 3 seconds to turn on.
Press and hold for 3 seconds again to turn off.

Pump ON/OFF

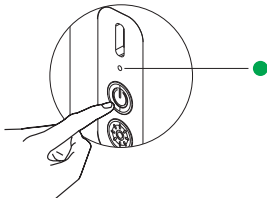

Press shortly to activate the pump.
Press shortly again to turn the pump off.

Lantern procedure

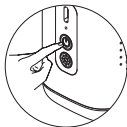

1. Press and hold for 3 seconds to turn on



2. Press light button shortly for medium light

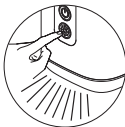

3. Press once more for strong light

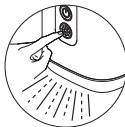

4. Press once more for blinking mode

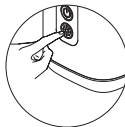

5. Press once more to turn off